



**CATEYE
SYNC™**

CatEyeSYNC™

Manual

Information in the instruction manual is subject to change without notice.

CatEyeSYNC-181106 2

Introduction

Pairing with a Light

Operating the Light

Operation and Changing Settings with CatEyeSYNC™

Firmware Update

Frequently Asked Questions

**Instruction Manual (PDF)
for CatEyeSYNC™-
Compatible Lights**

Introduction

CatEyeSYNC™ is an app that enables synchronization of multiple lights when used with paired CatEyeSYNC™-compatible lights. The on/off and mode change operations of paired lights can be synchronized regardless of whether CatEyeSYNC™ is open, while the app can be used to configure light settings, check remaining battery levels, and receive notifications.

Before Use

A smartphone and CatEyeSYNC™-compatible light are required to use CatEyeSYNC™.



Smartphone

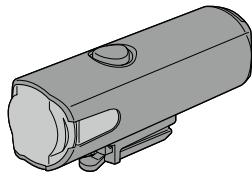

SYNCCore™

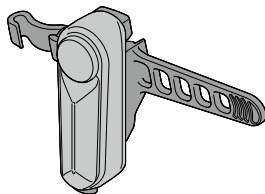

SYNCKinetic™

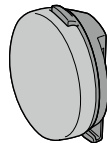

SYNCWearable™

- * For the latest information on compatible smartphones, see [“CatEyeSYNC™ Compatible Devices”](#).
- * CatEyeSYNC™ can be used to pair up to 7 lights.

Pairing with a Light

Pairing with CatEyeSYNC™ is required to synchronize the lights.



1. Install CatEyeSYNC™ on your smartphone.

For iPhone

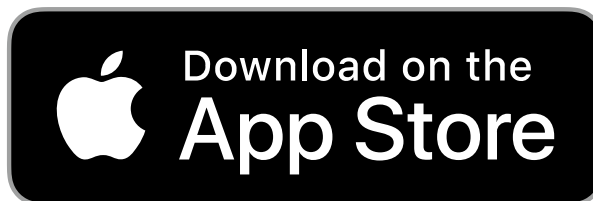

For Android smartphone



- * Downloading and using the app incurs communication fees. A Wi-Fi connection is recommended.

2. Open CatEyeSYNC™ and begin pairing.

- * Make sure the Bluetooth® function of the smartphone is turned on.

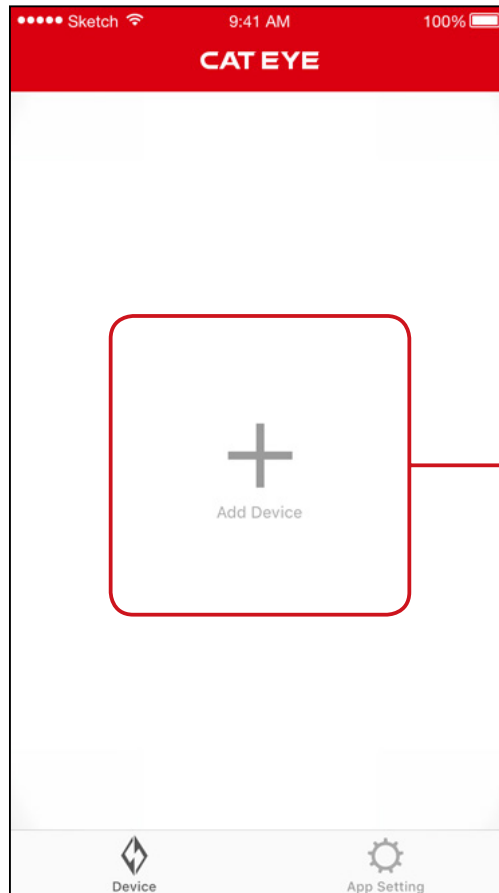

Tap the screen.

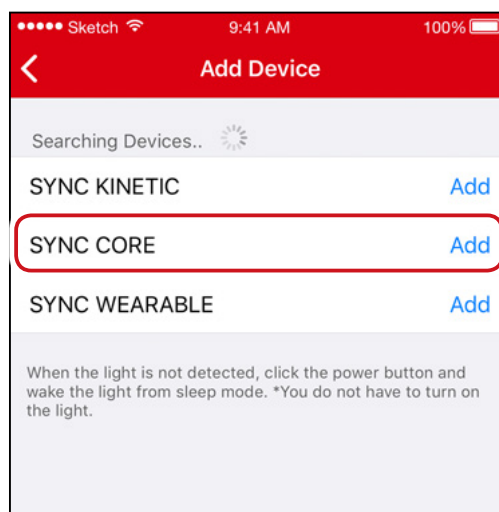
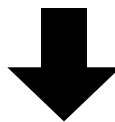

Tap on a detected light.

- * If no light is detected, click the switch on the light to be paired once.

There is no need to turn the light on.

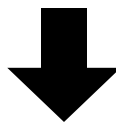
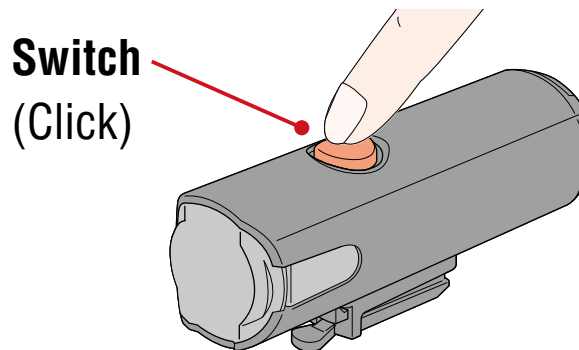

The light will flash, and a message will be displayed on the screen.

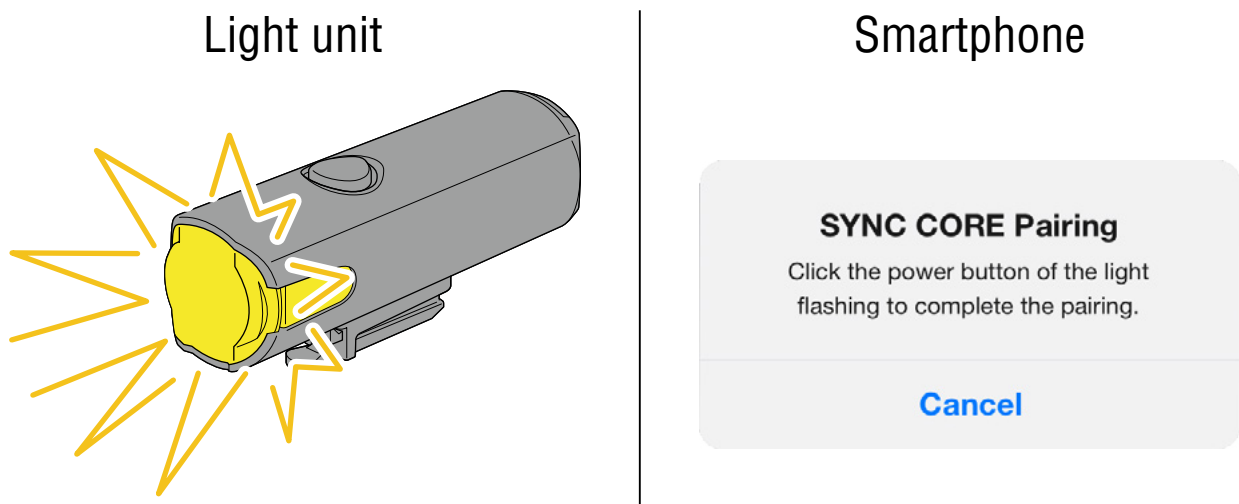

- * If the light does not flash, tap [Cancel], check the name of the light on the screen, and then tap [Add].

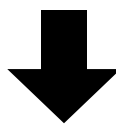

Click the switch on the flashing light.

The light will turn on and pairing will be complete.

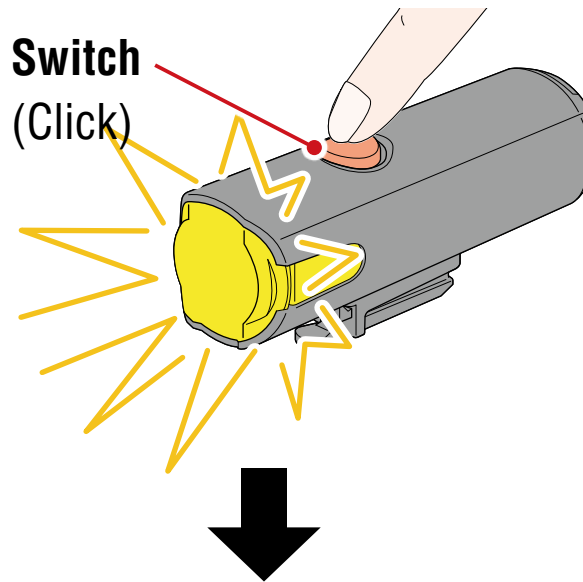

When paired with a headlight, the following message will be displayed.

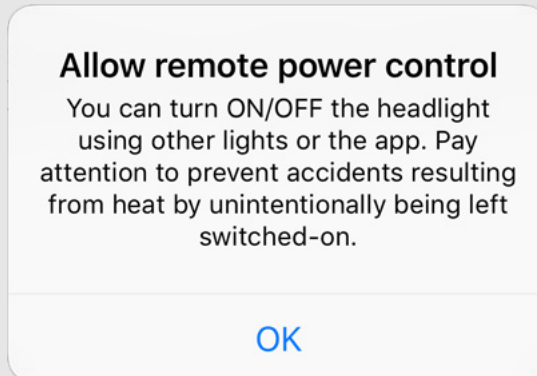

Tap [OK].

Repeat the process to pair with other lights.

Operating the Light

Operation of the switch on a paired light or of CatEyeSYNC™ will be carried out as follows.

⚠ Caution!

Synchronization may be affected by the communication environment or the usage situation.

* The CatEyeSYNC™ default status is used here as an example.

On/Off Operation (Press and hold the switch)

Switch operation of any light turn all lights on/off.

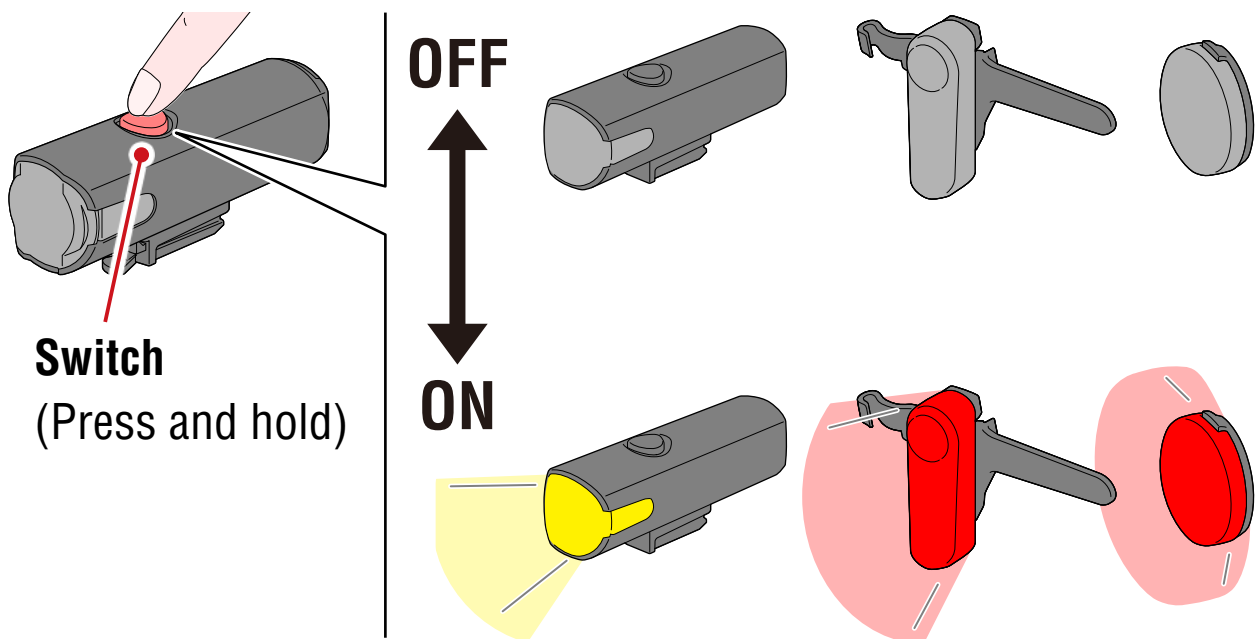

Mode Change (Press the switch)

● Headlight

Mode change will not be synchronized with other lights.

● Taillight, Safety Light

Mode change will be synchronized with all taillights and safety lights.

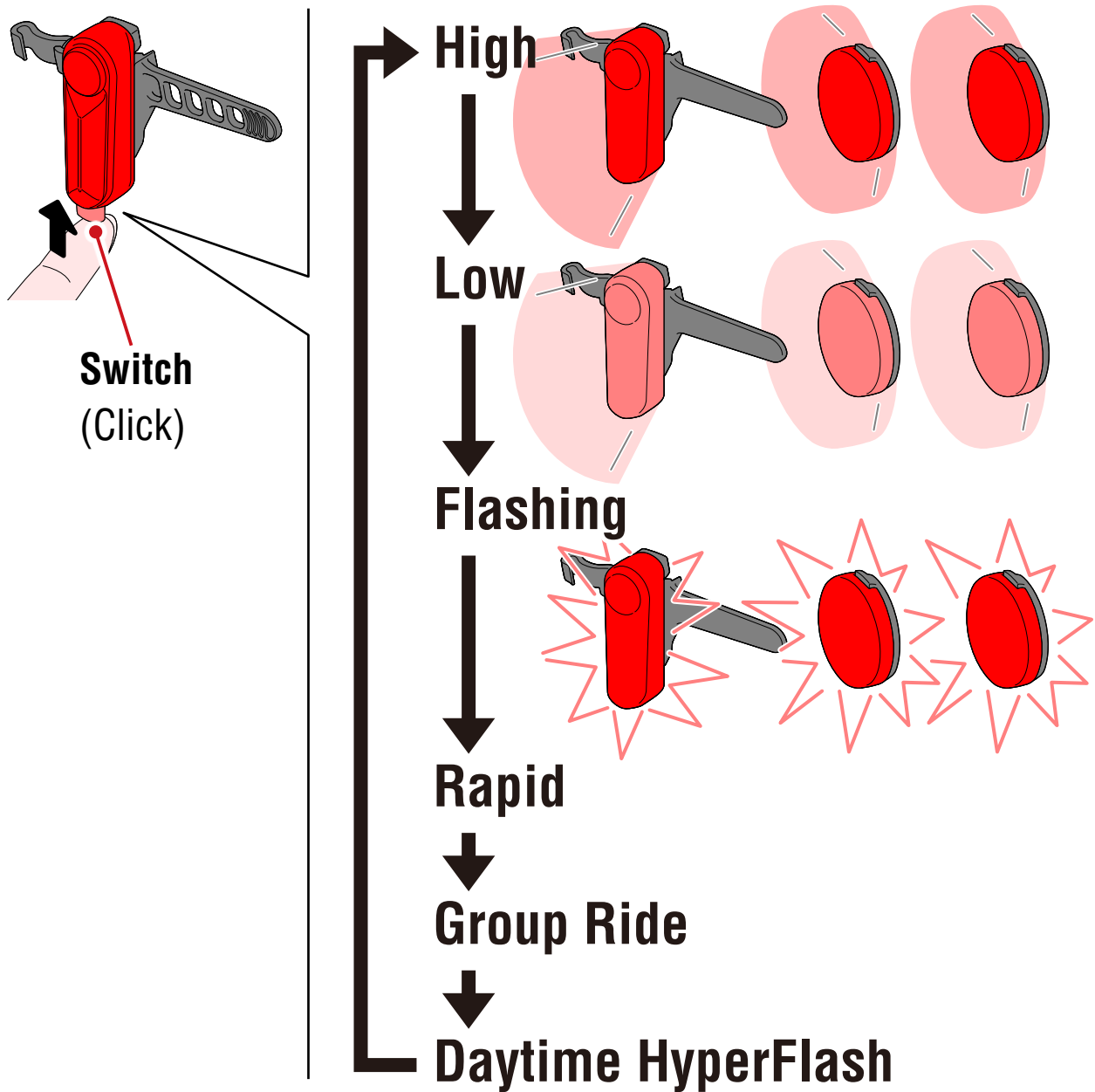

Kinetic Operation

Important : Connection of a light with kinetic function is required.

When a light with kinetic function senses deceleration, all paired taillights and safety lights will illuminate brighter for 2.5 seconds in kinetic mode.

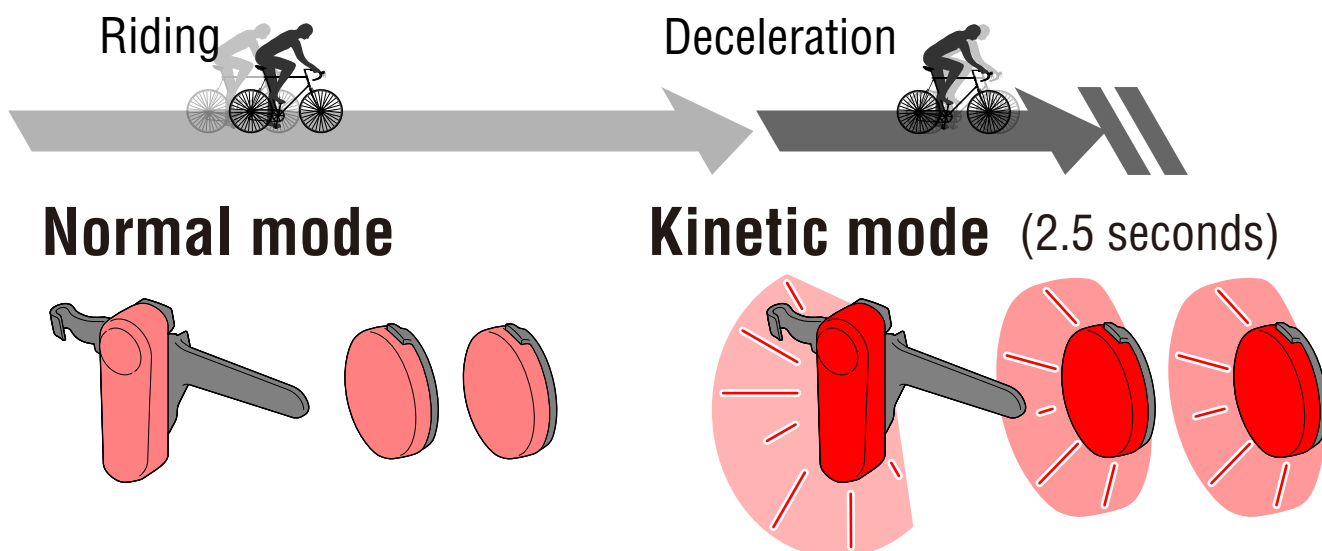

Standby and Sleep



CatEyeSYNC™-compatible lights have a standby state that allows connection to be maintained, and a sleep state running power-saving function.

State	Description
Standby	<ul style="list-style-type: none"> ● Connection can be established immediately when CatEyeSYNC™ is activated, and operation is possible from the app. ● Can synchronize with other paired lights even when CatEyeSYNC™ is not open. <p>* After use, if the light is not used again within about 4 days, the light will enter the sleep state.</p>

Sleep	<ul style="list-style-type: none"> ● No connection can be established even when CatEyeSYNC™ is activated. ● Cannot synchronize with other paired lights. <p>* Click the switch on the light. The light's LED will flash three times, indicating that the light is in the standby state.</p>
--------------	---

Light Connection Status

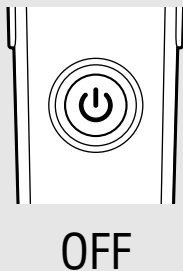
The indicator on a paired headlight can be used to check the connection status and remaining battery levels of other lights.

Indicator	State
 <p>OFF</p>	Other lights are disconnected.
 <p>Steady (green)</p>	At least one other light is currently connected.
 <p>Flashing (green)</p>	Other lights are low in battery.

Operation and Changing Settings with CatEyeSYNC™

Tap the desired light from the CatEyeSYNC™ home screen (device list).

* To change the settings, the light must be connected with CatEyeSYNC™.

Home screen (Device list)

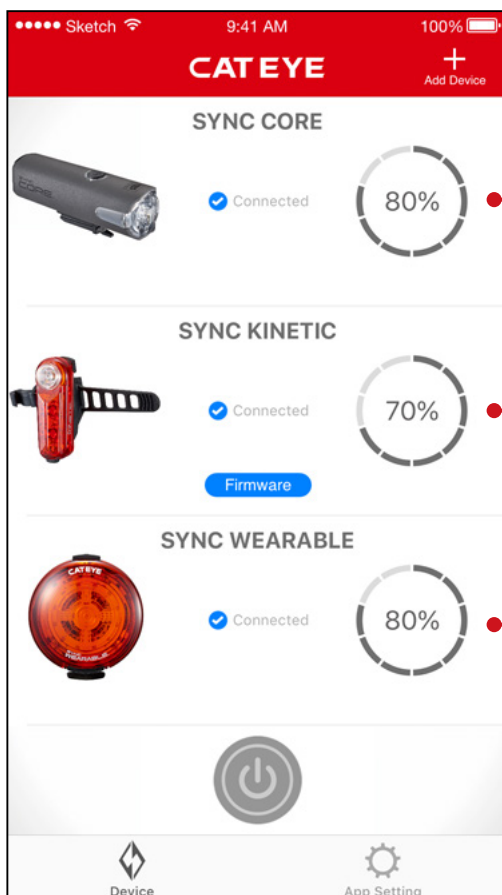

Tap to go to the headlight device screen

Tap to go to the taillight device screen

Tap to go to the safety light device screen

Headlight

Device screen

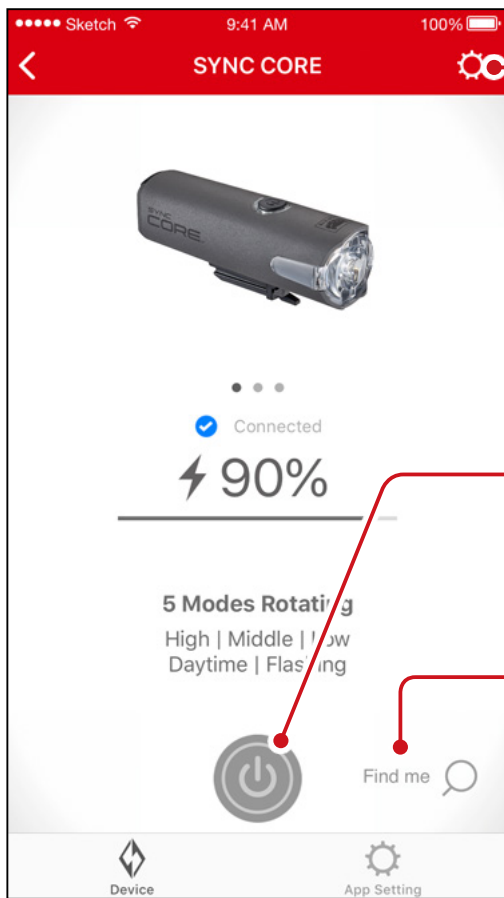

Tap to go to the setting screen

Switch

Press and hold to turn the light on/off.

Find me (*) / Mode

* The selected light will flash for several seconds.

Setting screen

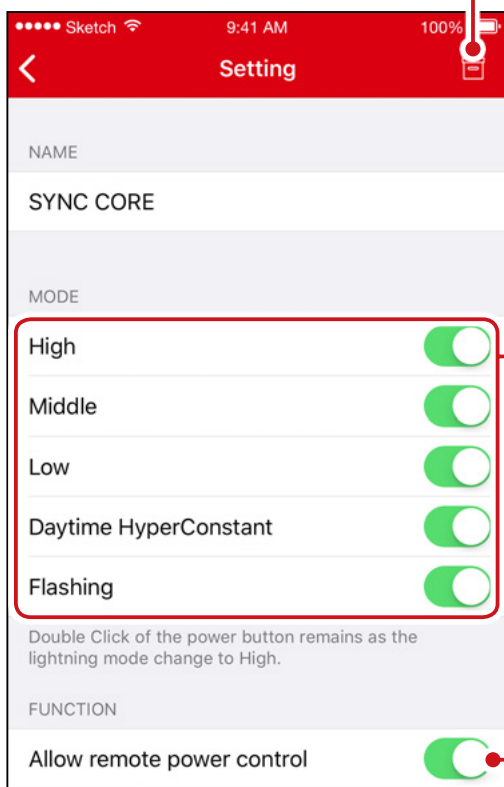

Unpair icon

Unpairs the light.

* Unpairing can also be performed by pressing and holding the switch on the light for 10 seconds.

Mode selection

Modes that have been turned off will be removed.

Allow remote power control

Turn on/off synchronization with CatEyeSYNC™ or other lights.

Taillight, Safety Light

Device screen (Shared)

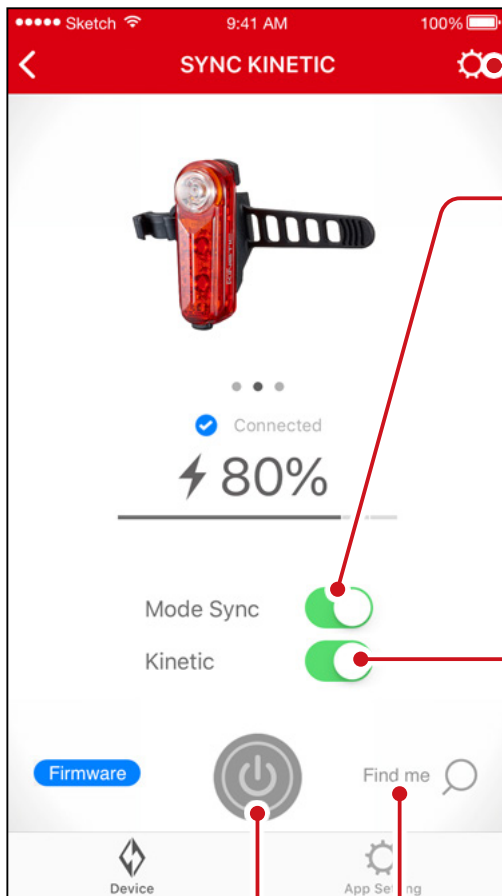

Tap to go to the setting screen

Mode Sync

Turn on/off synchronization of mode change.

* On/off operation will remain synchronized even when Mode Sync is turned off.

Kinetic

Turn on/off synchronization of Kinetic mode in rear lights. Kinetic mode is activated when deceleration is detected.

* Connection of a light with kinetic function is required.

Find me (*) / Mode

* The selected light will flash for several seconds.

Switch

Press and hold to turn the light on/off.

Setting screen (Taillight)

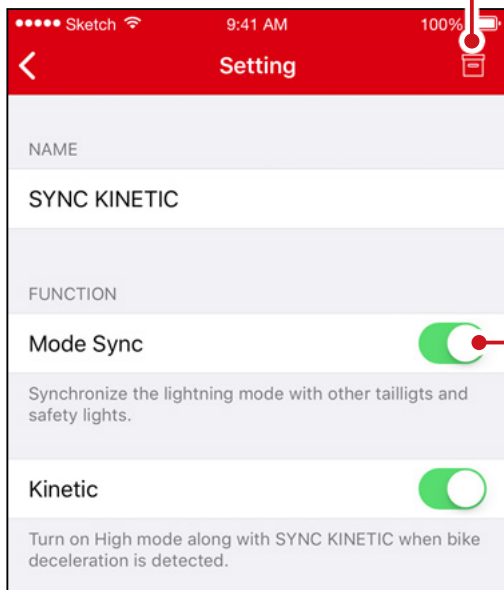

Unpair icon

Unpairs the light.

* Unpairing can also be performed by pressing and holding the switch on the light for 10 seconds.

Mode Sync

Setting screen (Safety Light)

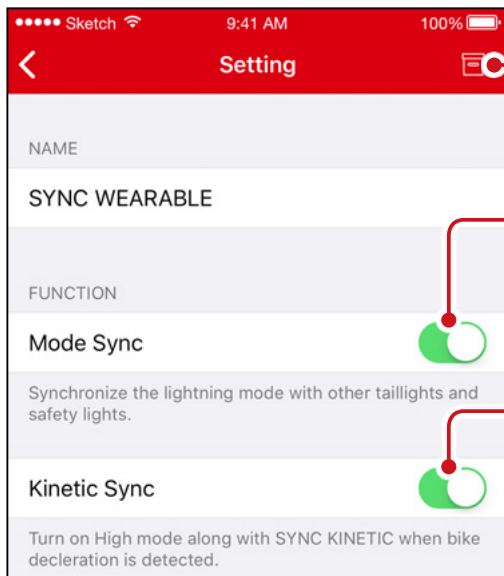

Unpair icon

Mode Sync

KineticSync

* The safety light itself does not have a kinetic function.

Firmware Update

Update Notifications

When a new firmware version is available, CatEyeSYNC™ will show a notification.

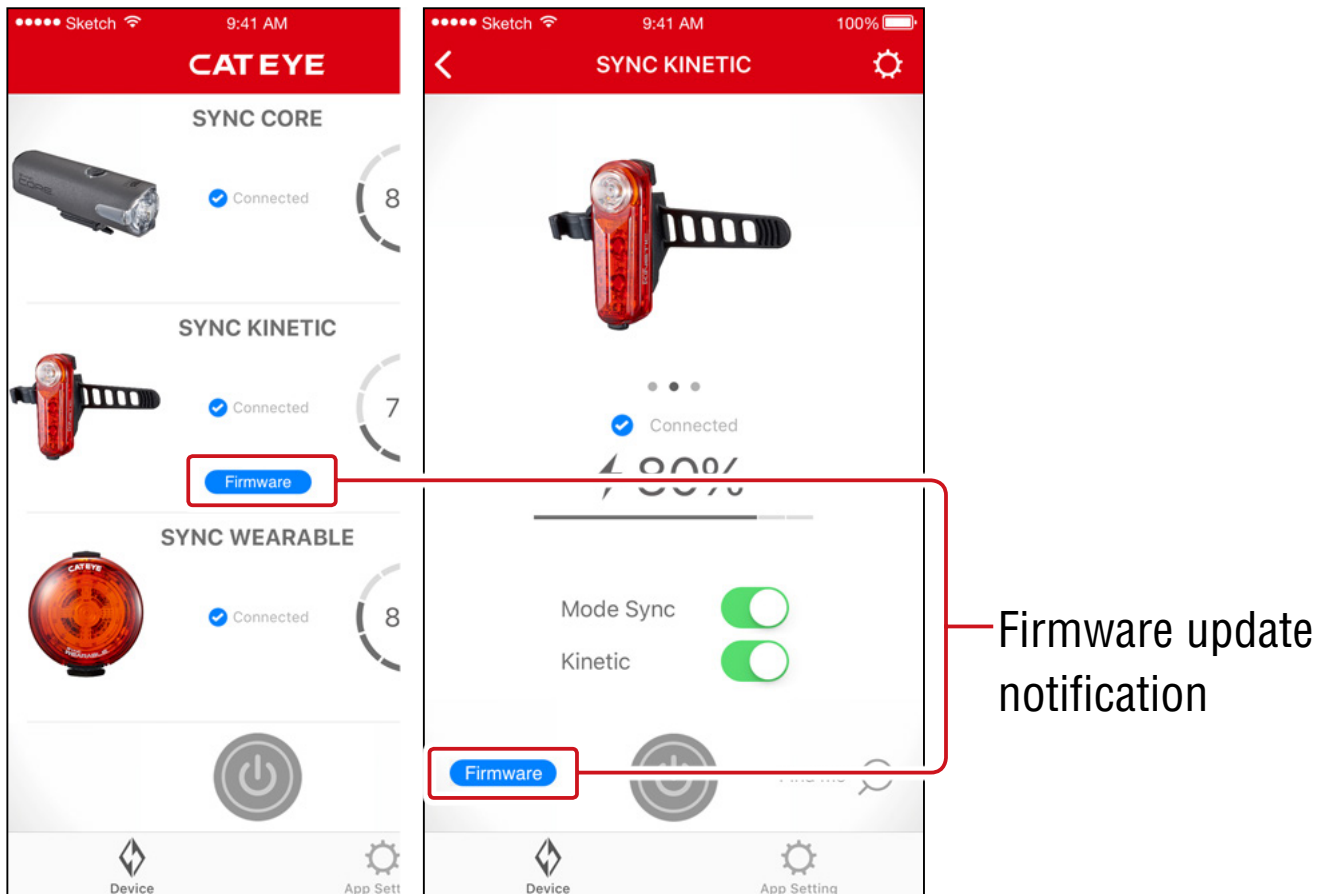

Installing and Executing Firmware Updater for CatEyeSYNC™

To update the firmware, install Firmware Updater for CatEyeSYNC™ on your PC.

* The PC must be connected to the Internet.

**Operating environment : Windows 7 / 8 / 8.1 / 10, or
Mac OS 10.10 or later**

1. [Download the updater](#) from the CATEYE website.

Download location

Home page

> SUPPORT

> Downloads

> Software and App

> Firmware Updater for CatEyeSYNC™

2. Download the Firmware Updater for CatEyeSYNC™ that matches your OS.

After download is complete, follow the on-screen instructions to install.

Executing Firmware Updater for CatEyeSYNC™

* The PC must be connected to the Internet.

1. Start Firmware Updater for CatEyeSYNC™.

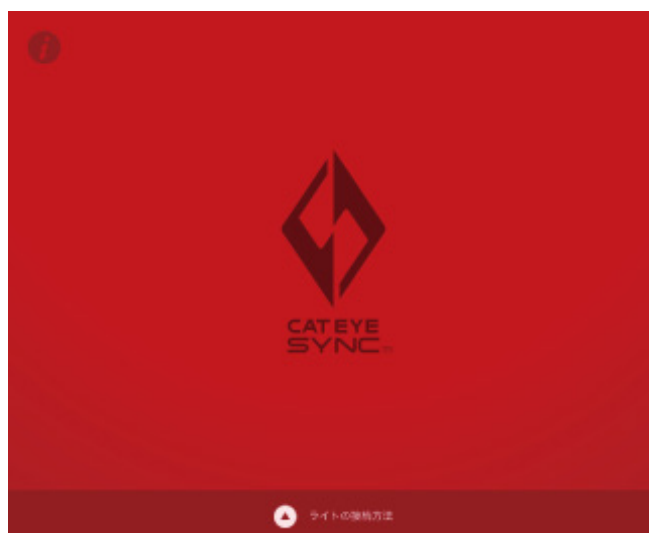

2. Follow the on-screen instructions to connect the light to a PC and update the firmware.

- Important :**
- **Be sure to use the included USB cable when connecting a light to a PC.**
 - **Do not simultaneously connect any other lights.**
 - **Do not power off the PC or disconnect the light while updating. Doing so may damage the light.**

Click [Update] button to begin updating. Wait until a dialog appears with the message [Updating complete].

3. After the update is complete, disconnect the light.

After updated, the light will enter a sleep state.

Click the switch on the light to wake the light.

Frequently Asked Questions

General Knowledge and Use

What is CatEyeSYNC™?

CatEyeSYNC™ is an app that enables synchronization of multiple lights when used with paired CatEyeSYNC™-compatible lights. In addition to synchronization of the on/off operation and mode switching for paired lights, CatEyeSYNC™ can also be used to customize light modes and to check the remaining battery level of lights.

Will the lights be synchronized even when the light is disconnected from CatEyeSYNC™?

All paired lights will remain synchronized even when CatEyeSYNC™ is not open.

How do I connect a paired light to CatEyeSYNC™?

Simply open CatEyeSYNC™ to connect the light.

* Connection can be established even when CatEyeSYNC™ is only running in the background.

How do I add a light purchased later?

From the CatEyeSYNC™ home screen, tap [+] to begin pairing. For details, refer to [“Pairing with a Light” \(page 3\)](#).

Can I turn off synchronization of a specific light?

Press and hold the switch on the light for 3 seconds.

The LED on the light will flash three times, forcing the light into a sleep state. In this state, the light is not connected to CatEyeSYNC™ or other lights.

To reconnect the light, click the switch on the light. The LED on the light will flash three times to show that connection to CatEyeSYNC™ and other lights is possible.

When will notifications be displayed on the smartphone?

A notification is displayed when the remaining battery power is low and the indicator turns on, or when charging is complete and the charging indicator turns off.

* Turn on “Lights Battery” notification in “App Setting”.

Troubleshooting

The light does not connect to CatEyeSYNC™ or other lights, or is not synchronized.

It is likely that the communication environment and the usage situation is preventing ON/OFF synchronization.

Directly operate the light failed in synchronization.

- * Some usage situations may result in connection/synchronization taking a few moments.

After about 4 days without use, the light will enter a sleep state ([page 9](#)), which will prevent communication. If this happens, click the switch on the light to wake the light. The light can then be connected to CatEyeSYNC™ or other lights.

- * The LED on the light will flash three times when the light wakes up.

The light cannot be connected to CatEyeSYNC.

Restart the smartphone.

The firmware update does not finish, or an alert is displayed.

Try updating the firmware again from the beginning.

- * Be sure to use the included USB cable when connecting a light to a PC.
- * Do not simultaneously connect any other lights.

- * For information on charging the light or individual operations, refer to the “[Instruction Manual \(PDF\) for CatEyeSYNC™-Compatible Lights](#)”.

CATEYE CO., LTD.

2-8-25, Kuwazu, Higashi Sumiyoshi-ku, Osaka 546-0041 Japan

Attn: CATEYE Customer Service

Phone : (06)6719-6863

Fax : (06)6719-6033

E-mail : support@cateye.co.jp

URL : <https://www.cateye.com>

[For US Customers]

CATEYE AMERICA, INC.

2825 Wilderness Place Suite 1200, Boulder CO 80301-5494 USA

Phone : 303.443.4595

Toll Free : 800.5.CATEYE

Fax : 303.473.0006

E-mail : service@cateye.com