



# CATEYE

## VELO WIRELESS +

### CYCLOCOMPUTER CC-VT210W

#### Owner's Manual

U.S. Pat. Nos. 5236759/5308419/6957926 Pat./Design Pat. Pending  
 Copyright© 2011 CATEYE Co., Ltd.  
 CCVT21W-110930 066600910 3



## INSTALL

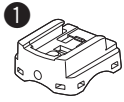

Uchwyt



Czujnik



Magnes

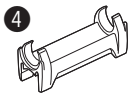

Podkładka gumowa do czujnika

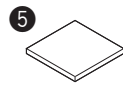

Taśma klejąca dwustronna

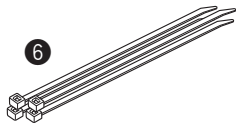

Nylonowe ściągna (x4)

A

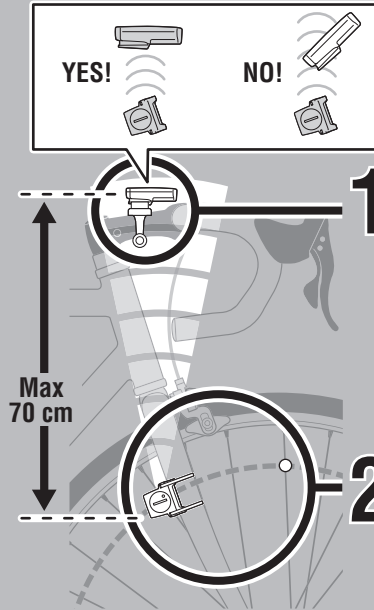

## 1 Bracket

[Stem]

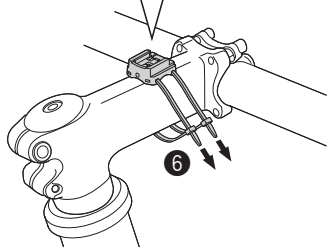
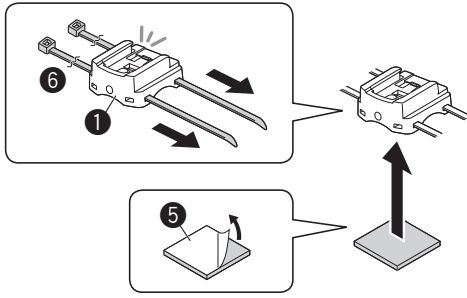

[Handlebar]

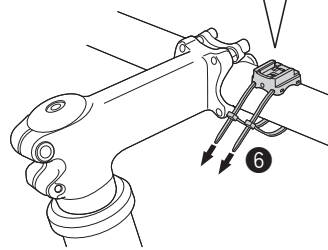
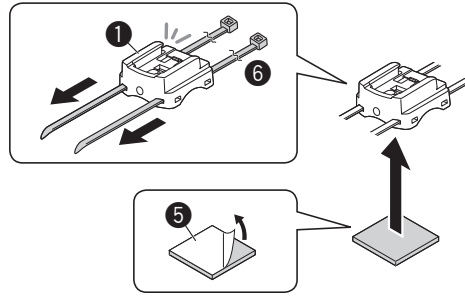

or

## 2 Sensor/Magnet

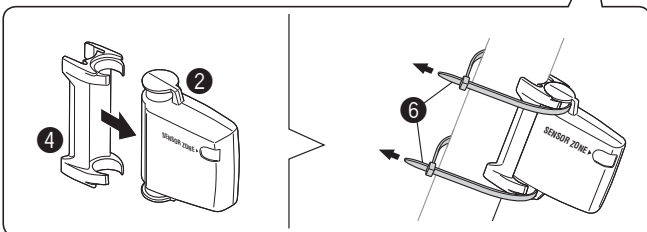
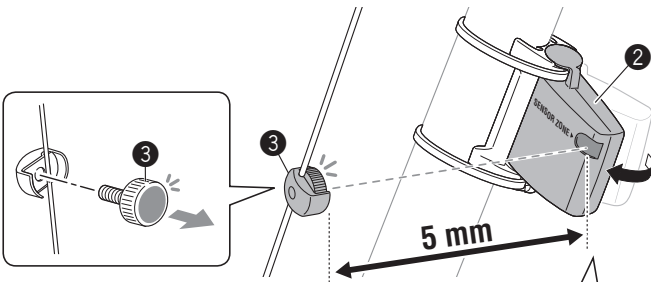

B



C

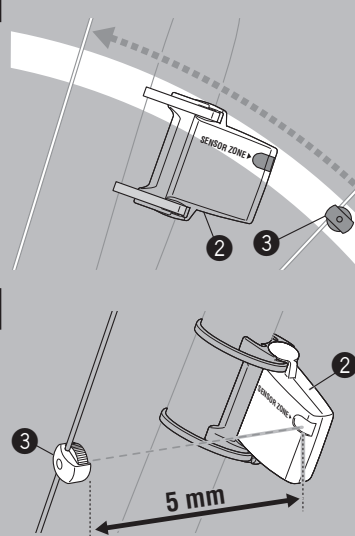

PL

CC-VT210W VELO WIRELESS +

# SETTING

## 1 | All Clear

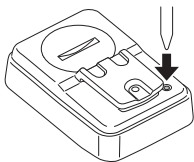

TM	= 0
DST	= 0
AV	= 0
MX	= 0
CAL	= 0
CO2	= 0
ODO	= 0
<input checked="" type="checkbox"/>	= 0

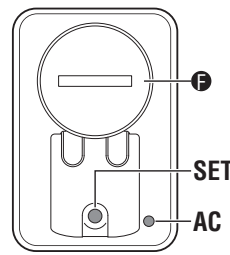
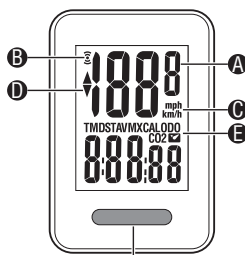

MODE

- A Aktualna prędkość
- B Ikona odbioru sygnału z czujnika
- C Jednostka prędkości km/h mph
- D Strzałka tempa ▲▼

- F Wybrany tryb
  - AC Obudowa przedziału baterii
- \* W celu uzyskania dalszych informacji, patrz rozdział „Nazwy komponentów”.

## 2 | Select km/h or mph

Set: km/h

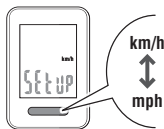

Register the setting SET

## 3 | Tire Size

[Quick setting size]



Set: 27"

or

[Detailed setting size]



ETRTO	Tire size	L (cm)
28-630	27x1-1/8	216
32-630	27x1-1/4	216
37-630	27x1-3/8	217
18-622	700x18C	207

Set: 216

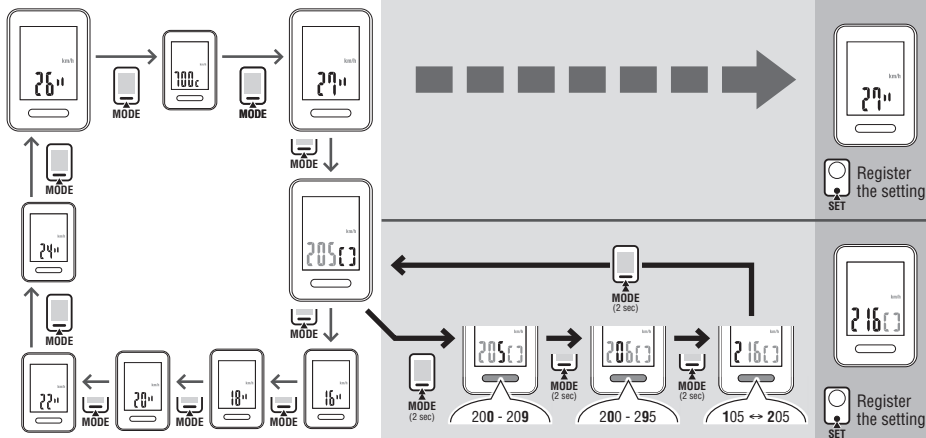

Register the setting SET

Register the setting SET

## 4 | Clock Setting

Set: 12h - 3:10

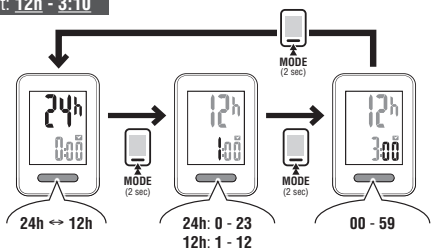

Register the setting (Finish) SET

# OPERATION FLOW

**Current Speed**  
0.0(4.0) - 105.9 km/h  
[0.0(3.0) - 65.9 mph]

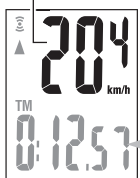

TM	0:12.57	TM	0:00.00 - 9:59.59
DST	1.23	DST	0.00 - 999.99 km [mile]
AV	14.6	AV *1	0.0 - 105.9 km/h [0.0 - 65.9 mph]
MX	30.1	MX	0.0(4.0) - 105.9 km/h [0.0(3.0) - 65.9 mph]
CAL	263	CAL *2	0 - 99999 kcal
CO2	0.18	CO2 *3	0.00 - 999.99 kg
ODO	12345	ODO	0 - 99999 km [mile]
<input checked="" type="checkbox"/>	15:38		0:00 - 23:59 [1:00 - 12:59]

### Data Reset



MODE (2 sec)

TM	= 0
DST	= 0
AV	= 0
MX	= 0
CAL	= 0
CO2	= 0

### Battery

#### Computer

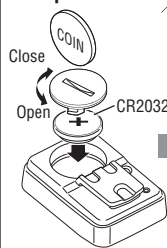

SETTING 1.All clear

#### Sensor

